

FORM CA16

**Application Form for Deposits under section 31(6) of the Highways Act
1980 and section 15A(1) of the Commons Act 2006**

1. Guidance relating to completion of this form is available from <http://defra.gov.uk/rural/protected/greens/>. Please refer to these separate notes when completing this form.
2. Parts A and F must be completed in all cases.
3. The form must be signed and dated by, or by a duly authorised representative of, every owner of land to which the application relates who is an individual, and by the secretary or some other duly authorised officer of every owner of land to which the application relates which is a body corporate or an unincorporated association.
4. In the case of land in joint ownership all the joint owners must complete paragraphs 2 and 3 of Part A and complete and sign the application in Part F, unless a duly authorised representative completes and signs the form on behalf of all the owners of the land. Paragraph 3 should be completed in full to clearly explain the capacity of each applicant e.g. trustee, landowner's managing agent, executor.
5. 'Owner' is defined in section 61(3) of the Commons Act 2006 and section 31(7) of the Highways Act 1980 and means, broadly, a legal owner of the freehold interest in the land.
6. Where the application relates to more than one parcel of land, a description of each parcel should be completed to clearly identify which statement and/or declaration relates to which parcel of land. This may require the insertion of additional wording. See separate notes for further guidance. Multiple parcels of land should be clearly identified by coloured edging on any accompanying map.
7. Where a statement or declaration requires reference to colouring shown on an accompanying map or previously lodged map, the colouring must be clearly specified and must match that shown on the relevant map. For example, if a footpath is specified in a Part C declaration as shown coloured brown, the accompanying map or previously deposited map referred to must reflect that colouring.
8. An application must be accompanied by an ordnance map, or (in respect of declarations under Part C or statements under Part D of this form) refer to a map previously deposited in accordance with the Commons (Registration of Town or Village Greens) Dedicated Highways (Landowner Statements and Declaration) (England) Regulations 2013 or (if deposited before 1st October 2013) in accordance with section 31(6) of the Highways Act 1980. Any accompanying map must be an ordnance map at a scale of

not less than 1:10,560 showing the boundary of the land to which the application relates in coloured edging.

9. An application must be accompanied by the requisite fee – please ask the appropriate authority for details.

PART A

PART A: Information relating to the application and land to which the application relates

(all applicants must complete this Part)

1. Name of appropriate authority to which the application is addressed:
Bath and North East Somerset
2. Name and full address (including postcode) of applicant:
Dr D S & Mrs J M Dickerson,
24 Highmead Gardens,
Bishop Sutton,
Bristol.
BS39 5XB.
3. Status of applicant (tick relevant box or boxes):

We are
 - (a) ☒ the owner of the land described in paragraph 4.
 - (b) ☐ making this application and the statements/declarations it contains on behalf of [*insert name of owner*] who is the owner of the land(s) described in paragraph 4 and in my capacity as [*insert details*].
4. Insert description of the land(s) to which the application relates (including full address and postcode):
Field to the south of Highmead Gardens, Bishop Sutton, Bristol. BS39 5XB.
5. Ordnance Survey six-figure grid reference(s) of a point within the area of land(s) to which the application relates (if known): 587,593
OS X (Eastings) 358705
OS Y (Northings) 159347
Nat Grid ST587593 / ST5870559347
6. This deposit comprises the following statement(s) and/or declarations:
Part B, Part D, Part E and Part F.

PART B

PART B: Statement under section 31(6) of the Highways Act 1980

We are the owners of the land described in paragraph 4 of Part A of this form and shown within the blue border on the map accompanying this statement.

The Way shown in red on the accompanying map is a public footpath.

No other ways over the land shown within the blue border on the accompanying map has been dedicated as highways.

24, HIGHMEAD GARDENS, BRISTOL, BATH AND NORTH EAST SOMERSET, BS39 5XB

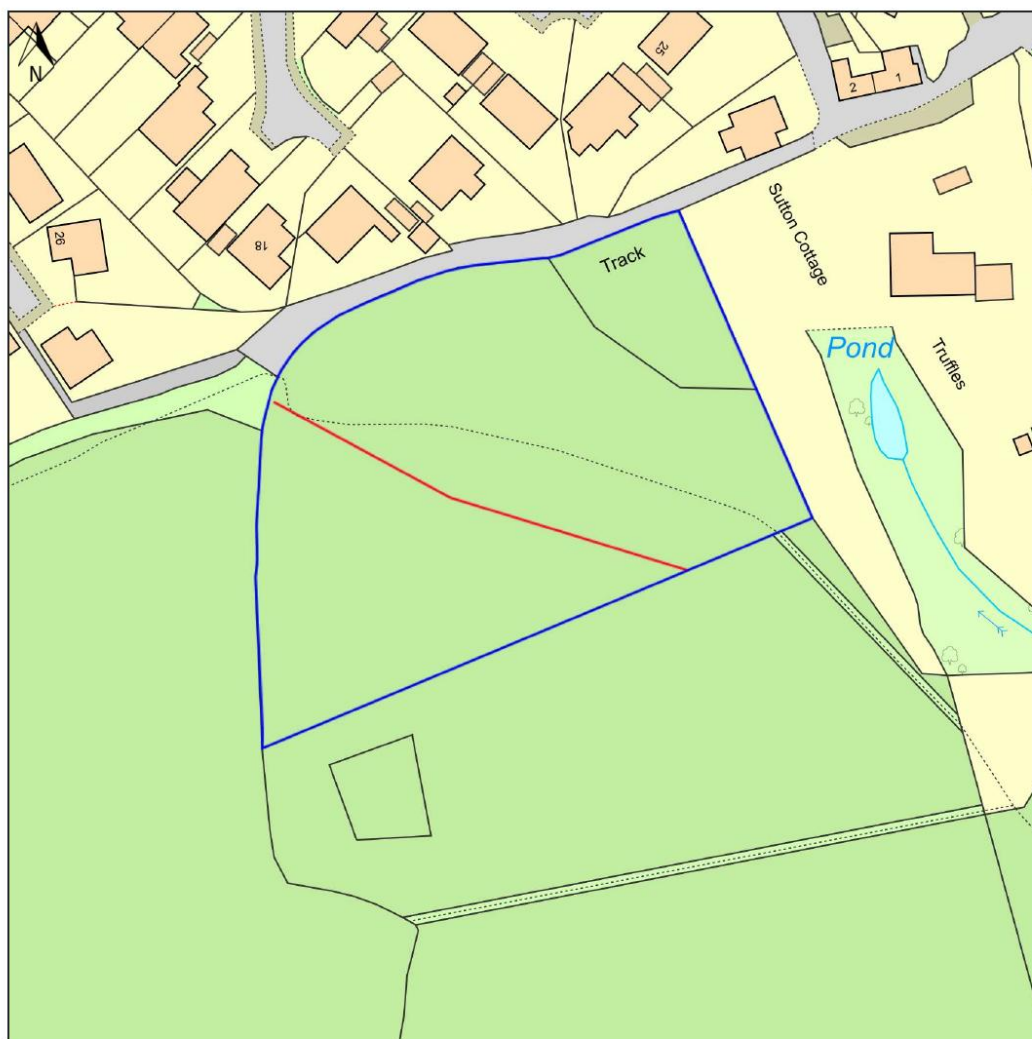

© Crown copyright and database rights, 2025. Ordnance Survey
AC0000808122 Created using Plans by Emapsite

0m 20m 40m 60m 80m 100m

Scale: 1:1250

Paper Size: A4

Notes:



PART D

PART D: Statement under section 15A(1) of the Commons Act 2006

We, Dr D S & Mrs J M Dickerson are the owners of the land described in paragraph 4 of Part A of this form and shown within the blue border on the map accompanying this statement, deposited with Bath & North East Somerset Council on 12th May 2025.

We wish to bring to an end any period during which persons may have indulged as of right in lawful sports and pastimes on the whole or any part of the land shown within the blue border on the accompanying map referred above.

PART E

PART E: Additional information relevant to the application (insert any additional information relevant to the application)

The location of the public footpath is based on the definitive map of Bath & North East Somerset shown below. The public have strayed from this track to the north-east as shown by the dotted line on the submitted plan where people have followed the contour of the land. Furthermore, the stile into the adjoining field to the south was replaced with a kissing gate by Bath & North East Somerset some 10 years ago but was located in the wrong position. To restore the location of the public footpath would cause significant difficulties to the neighbouring land owner who have enclosed the footpath with fencing across their land so the pragmatic solution would be to relocate the track of the footpath in a line between the two kissing gates into and out of the field. In the meantime, we will realign the public footpath to where it is shown on the definitive map once the hay has been harvested this year and allow people to walk the short distance from here to the kissing gate and vice versa.

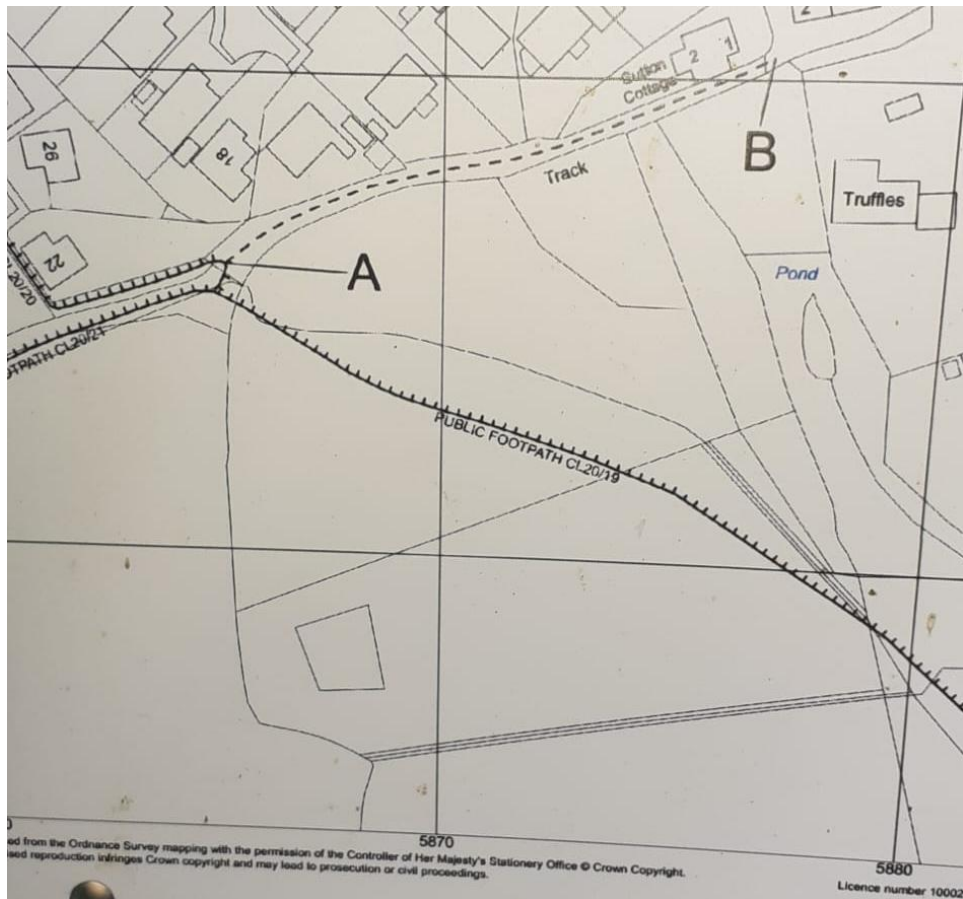

PART F

PART F: Statement of Truth (all applicants must complete this Part)

WARNING: If you dishonestly enter information or make a statement that you know is, or might be, untrue misleading, and intend by doing so to make a gain for yourself or another person, or to cause loss or the risk of loss to another person, you may commit the offence of fraud under section 1 of the Fraud Act 2006, the maximum penalty for which is 10 years' imprisonment or an unlimited fine, or both.

I BELIEVE THAT THE FACTS AND MATTERS CONTAINED IN THIS FORM ARE TRUE.

Signatures:

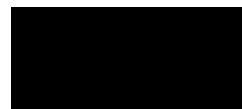

Print full name: Dr D S Dickerson

Mrs J M Dickerson

Date: 12th May 2025

You should keep a copy of the completed form.

Data Protection Act 2018 - Fair Processing Notice

The purpose of this Fair Processing Notice is to inform you of the use that will be made of your personal data, as required by the Data Protection Act 2018.

The appropriate authority (see explanation of definition in above guidance notes) in England is the data controller in respect of any personal data that you provide when you complete this form.

The information that you provide will be used by the appropriate authority in its duties to process applications to deposit statements, maps and declarations under section 31(6) the Highways Act 1980 and statements under section 15A(1) of the Commons Act 2006. The information you provide will also be used by the appropriate authority in its duty to update the registers in which details of such deposits are recorded under the Dedicated Highways (Registers under Section 31A of the Highways Act 1980) (England) Regulations 2007 and the Commons (Registration of Town or Village Greens) and Dedicated Highways (Landowner Statements and Declarations) (England) Regulations 2013.

The appropriate authority is required by the legislation above to maintain a register which holds information provided in this form, which can be inspected online or in person by members of the public on request. It may also be required to release information, including personal data and commercial information, on request under the Environmental Information Regulations 2004 or the Freedom of Information Act 2000. However, the appropriate authority will not permit any unwarranted breach of confidentiality nor will they act in contravention of their obligations under the Data Protection Act 2018.

